

SUGGESTED HOUSE WIDTH	(40)	MAN WATER VALVE	●
GARAGE LOCATION	(C)	SERVICE WATER VALVE	•
OPTIONAL GARAGE LOCATION	(C)	STREET LIGHT	⊙
WALKOUT BASEMENT	W/O	POWER PEDESTAL	△
BACK TO FRONT LOT DRAINAGE	B/F	POWER TRANSFORMER	□
SPLIT LOT DRAINAGE	S	SUPER MAILBOX	■
TREE	○	STREET SIGN	+
MAN HOLE	○	UTILITY LOT BARRIER	— —
HYDRANT	⊕	CONSTRUCT TO CITY OF GP STANDARD	— —
		PARAPLEGIC RAMP	▲

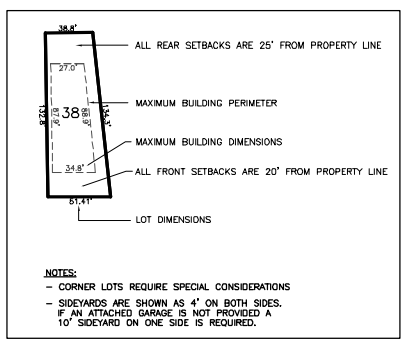

TREE LEGEND	SYMBOL
RUDOLPH CRABS	RUD
DOLGO CRABS	DC
ROYALTY CRAB	ROY
BRANDON ELMS	BE
FALL GOLD ASH	FG
SCHUBERTS	SC
AMUR CHERRY	AC
LINDEN	LIN
PAPER BIRCH	PB
ELM	E
SPRUCE	S

MARK	NATURE OF REVISION	DATE	ENGINEER

Existing	Proposed	San. Sewer, W. & Cap.	Storm Sizer & W. & Cap.	Existing	Proposed
Watermain	—	—	—	562	562
Valve	—	—	—	—	—
Hydrant	—	—	—	—	—
Tap	—	—	—	—	—
Reducer	—	—	—	—	—
Plug	—	—	—	—	—
Cap	—	—	—	—	—

Drawn By: GWA
Design By:
Checked By:
Date: DEC 20/11
Job No: 5240-030
Dwg. # 5240-030-J
Scale: 1" = 60'

O'BRIEN LAKE
RESIDENTIAL SUBDIVISION - PHASE 6
GRANDE PRAIRIE, ALBERTA

FOCUS Corporation
 #205, 10725 100 Street
 Grande Prairie, AB, Canada
 T6N 3J6
 Main: 780.532.3450
 Fax: 780.539.0867
 www.focus.ca
This drawing and design is protected under copyright, and any use, reproduction or modification is strictly prohibited without the written permission of Focus Corporation. These drawings should not be used for construction. The Contractor must check and verify all dimensions, and shall report any discrepancies or omissions prior to commencement of any work.